

	CUSTOMER	CUSTOMER CODE	PART DESCRIPTION HALL EFFECT CURRENT SENSOR CLOSED LOOP 6A		
	INTERNAL CODE HCT-DS5	DATE 28/10/10	EDITION 2	DOCUMENT NAME HCT-DS5_2.doc	PAGE 1/17

HCT-06DS5 SERIES HALL EFFECT CURRENT SENSOR CLOSED LOOP

NOTES



All rights reserved. Passing on of this document, use and communication of contents not permitted without written authorisation.

	CUSTOMER	CUSTOMER CODE	PART DESCRIPTION HALL EFFECT CURRENT SENSOR CLOSED LOOP 6A	
	INTERNAL CODE HCT-DS5	DATE 28/10/10	EDITION 2	DOCUMENT NAME HCT-DS5_2.doc

1.- DIMENSIONS AND PINS CONFIGURATION

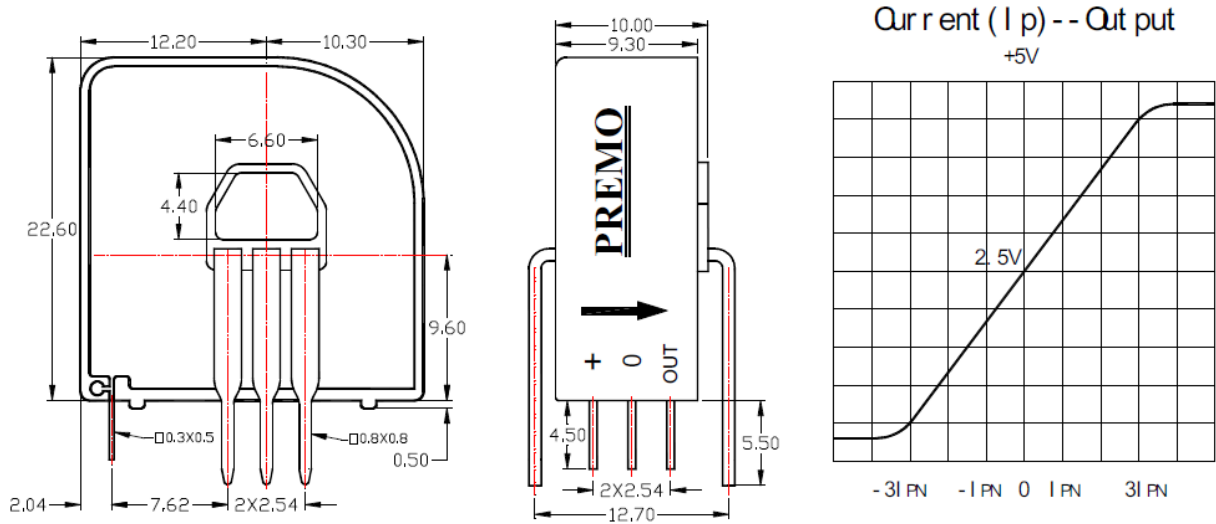

All dimensions are in mm.

General Tolerance ± 0.5 mm.

All dimensions and mechanical fixations are subjected to change depending on the customer necessities and PREMO Transducer Development.

Marking

Component is marked as follows:

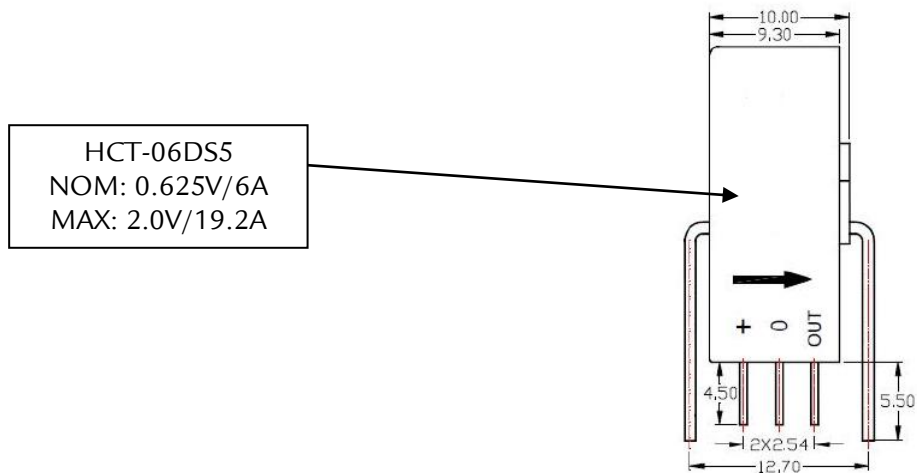

NOTES

All rights reserved. Passing on of this document, use and communication of contents not permitted without written authorisation.

	CUSTOMER	CUSTOMER CODE	PART DESCRIPTION HALL EFFECT CURRENT SENSOR CLOSED LOOP 6A		
	INTERNAL CODE HCT-DS5	DATE 28/10/10	EDITION 2	DOCUMENT NAME HCT-DS5_2.doc	PAGE 3/17

2.- ELECTRICAL PARAMETERS

Primary Nominal Current	6 A DC	I_{pn}
Measuring Range	19.2 A	I_p
Reference voltage	2.5±0.5% V	V_o
Turns	960±1	N
Supply Voltage	+5±5% V	V_{cc}
Rated output (V)	0.625±0.5%	
Sample resistance inside	100±0.1% Ω	R_{IN}

3.- ACCURACY

Linear Error	< 0.1 % Full Scale	e_{LLR}
Total precision	±0.7	
Offset Current Drift	<± 0.5 % mV/°C	K_{los}
Time Response (di/dt>50 A/μS)	< 500ns	T_R
Frequency Bandwidth	DC to 200kHz (-1dB)	F_c

4.- GENERAL DATA

Operating Temperature	-40 to +85 °C	T_A
Storage Temperature	-40 to +125 °C	T_s

5.- ISOLATION CHARACTERISTICS

Galvanic isolation (50 Hz, 1min)	2.5 KV	V_i
Impulse withstand voltage 1.2/50μs	>8 KV MIN	V_w
Creepage distance	15.5 mm	d_{Cp}
Clearance distance	6.35 mm	d_{Cl}

STANDARDS

	EN 50178	UL 508C
Rating isolation voltage	600V	600V
Pollution degree	2	2
CTI	III	III

Notes:

-To be certificated

NOTES

All rights reserved. Passing on of this document, use and communication of contents not permitted without written authorisation.

	CUSTOMER	CUSTOMER CODE	PART DESCRIPTION HALL EFFECT CURRENT SENSOR CLOSED LOOP 6A		
	INTERNAL CODE HCT-DS5	DATE 28/10/10	EDITION 2	DOCUMENT NAME HCT-DS5_2.doc	PAGE 4/17

6.- MOUNTING DIMENSIONS (FOR REFERENCE ONLY)

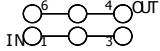
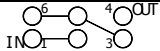
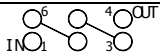
Turns	Primary rated current IPN[A]	Rated putout voltage VOUT[V]	Primary resistance [mΩ]	Primary Inductance [uH]	Connect point
1	±6	2.5±0.625	0.18	0.013	
2	±3	2.5±0.625	0.81	0.05	
3	±2	2.5±0.625	1.62	0.12	

7.- EDITION CONTROL

Edition	Date	Change description	Made by
1 st	25/08/10	First Edition	Marta Escolar
2 nd	28/10/10	Added the isolations characteristics and standards and marking, updated mounting dimensions	Marta Escolar

NOTES

All rights reserved. Passing on of this document, use and communication of contents not permitted without written authorisation.

	CUSTOMER	CUSTOMER CODE	PART DESCRIPTION HALL EFFECT CURRENT SENSOR CLOSED LOOP 6A		
	INTERNAL CODE HCT-DS5	DATE 28/10/10	EDITION 2	DOCUMENT NAME HCT-DS5_2.doc	PAGE 5/17

HCT-15DS5 SERIES HALL EFFECT CURRENT SENSOR CLOSED LOOP

NOTES



All rights reserved. Passing on of this document, use and communication of contents not permitted without written authorisation.

	CUSTOMER	CUSTOMER CODE	PART DESCRIPTION HALL EFFECT CURRENT SENSOR CLOSED LOOP 6A	
	INTERNAL CODE HCT-DS5	DATE 28/10/10	EDITION 2	DOCUMENT NAME HCT-DS5_2.doc

1.- DIMENSIONS AND PINS CONFIGURATION

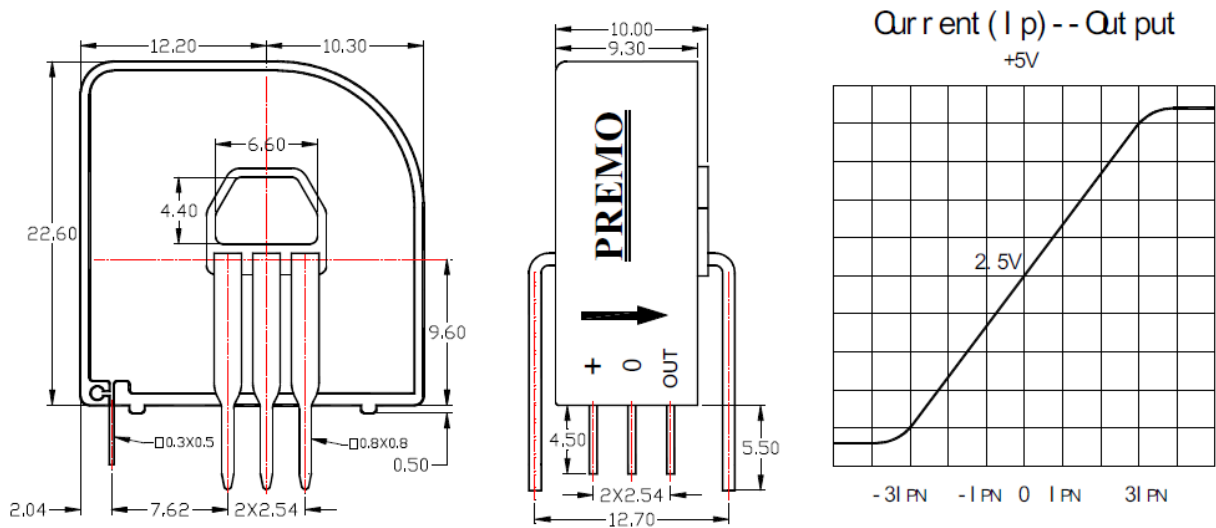

All dimensions are in mm.

General Tolerance ± 0.5 mm.

All dimensions and mechanical fixations are subjected to change depending on the customer necessities and PREMO Transducer Development.

Marking

Component is marked as follows:

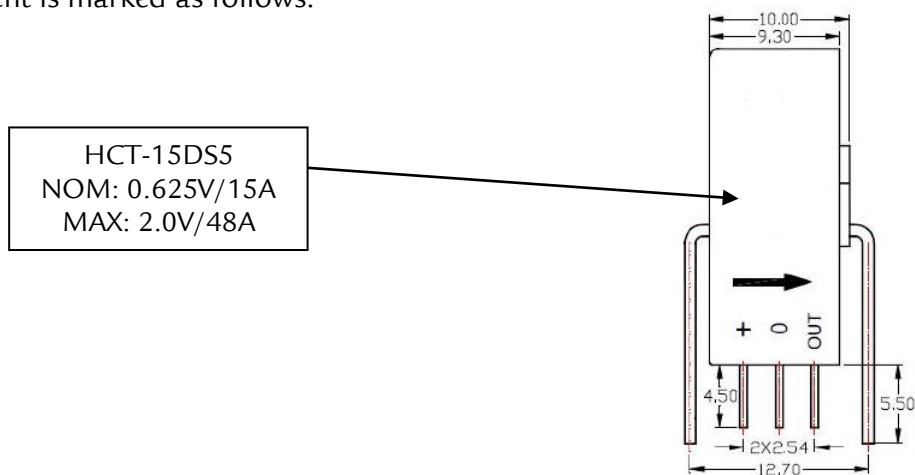

NOTES

All rights reserved. Passing on of this document, use and communication of contents not permitted without written authorisation.

	CUSTOMER	CUSTOMER CODE	PART DESCRIPTION HALL EFFECT CURRENT SENSOR CLOSED LOOP 6A		
	INTERNAL CODE HCT-DS5	DATE 28/10/10	EDITION 2	DOCUMENT NAME HCT-DS5_2.doc	PAGE 7/17

2.- ELECTRICAL PARAMETERS

Primary Nominal Current	15 A DC	I_{pn}
Measuring Range	48 A	I_p
Reference voltage	2.5±0.5% V	V_o
Turns	1200±1	N
Supply Voltage	+5±5% V	V_{cc}
Rated output (V)	0.625±0.5%	
Sample resister inside	100±0.1% Ω	R_{IN}

3.- ACCURACY

Linear Error	< 0.1 % Full Scale	e_{LLR}
Total precision	±0.7	
Offset Current Drift	<± 0.5 % mV/°C	K_{Ios}
Time Response (di/dt>50 A/μS)	< 500ns	T_R
Frequency Bandwidth	DC to 200kHz (-1dB)	F_c

4.- GENERAL DATA

Operating Temperature	-40 to +85 °C	T_A
Storage Temperature	-40 to +125 °C	T_s

5.- ISOLATION CHARACTERISTICS

Galvanic isolation (50 Hz, 1min)	3 KV	V_i
Impulse withstand voltage 1.2/50μs	>8 KV MIN	V_w
Creepage distance	15.5 mm	d_{Cp}
Clearance distance	6.35 mm	d_{Cl}

STANDARDS

	EN 50178	UL 508C
Rating isolation voltage	600V	600V
Pollution degree	2	2
CTI	III	III

Notes:

-To be certificated

NOTES

All rights reserved. Passing on of this document, use and communication of contents not permitted without written authorisation.

	CUSTOMER	CUSTOMER CODE	PART DESCRIPTION HALL EFFECT CURRENT SENSOR CLOSED LOOP 6A		
	INTERNAL CODE HCT-DS5	DATE 28/10/10	EDITION 2	DOCUMENT NAME HCT-DS5_2.doc	PAGE 8/17

6.- MOUNTING DIMENSIONS (FOR REFERENCE ONLY)

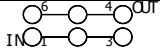
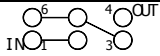
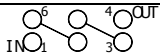
Turns	Primary rated current IPN[A]	Rated putout voltage VOUT[V]	Primary resistance [mΩ]	Primary Inductance [uH]	Connect point
1	±15	2.5±0.625	0.18	0.013	
2	±7.5	2.5±0.625	0.81	0.05	
3	±5	2.5±0.625	1.62	0.12	

7.- EDITION CONTROL

Edition	Date	Change description	Made by
1 st	25/08/10	First Edition	Marta Escolar
2 nd	29/10/10	Added the isolations characteristics, marking and standards, updated mounting dimensions	Marta Escolar

NOTES

All rights reserved. Passing on of this document, use and communication of contents not permitted without written authorisation.

	CUSTOMER	CUSTOMER CODE	PART DESCRIPTION HALL EFFECT CURRENT SENSOR CLOSED LOOP 6A		
	INTERNAL CODE HCT-DS5	DATE 28/10/10	EDITION 2	DOCUMENT NAME HCT-DS5_2.doc	PAGE 9/17

HCT-25DS5 SERIES HALL EFFECT CURRENT SENSOR CLOSED LOOP

NOTES



All rights reserved. Passing on of this document, use and communication of contents not permitted without written authorisation.

	CUSTOMER	CUSTOMER CODE	PART DESCRIPTION HALL EFFECT CURRENT SENSOR CLOSED LOOP 6A	
	INTERNAL CODE HCT-DS5	DATE 28/10/10	EDITION 2	DOCUMENT NAME HCT-DS5_2.doc

1.- DIMENSIONS AND PINS CONFIGURATION

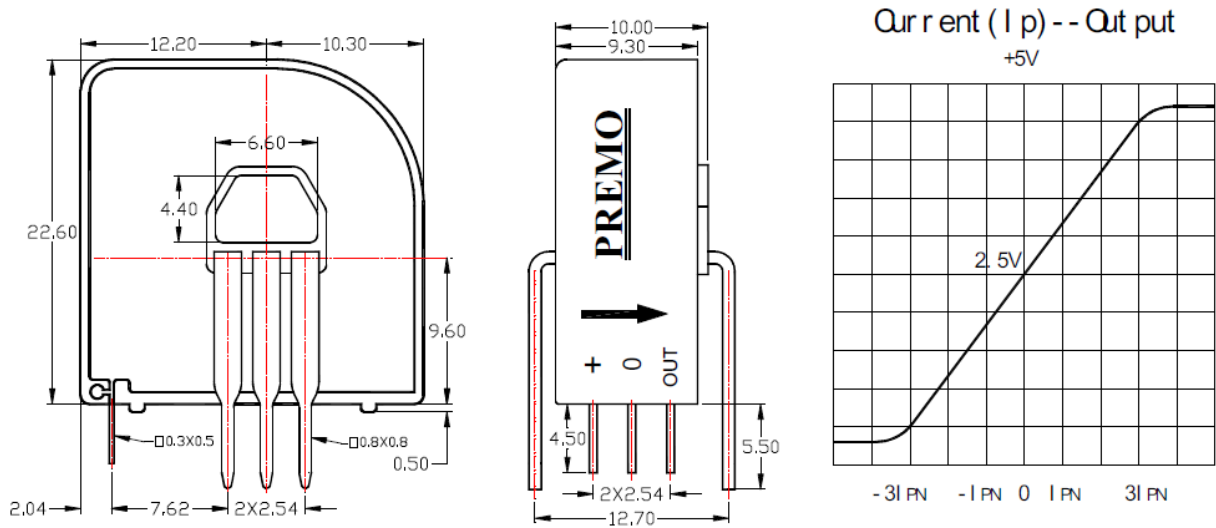

All dimensions are in mm.

General Tolerance ± 0.5 mm.

All dimensions and mechanical fixations are subjected to change depending on the customer necessities and PREMO Transducer Development.

Marking

Component is marked as follows:

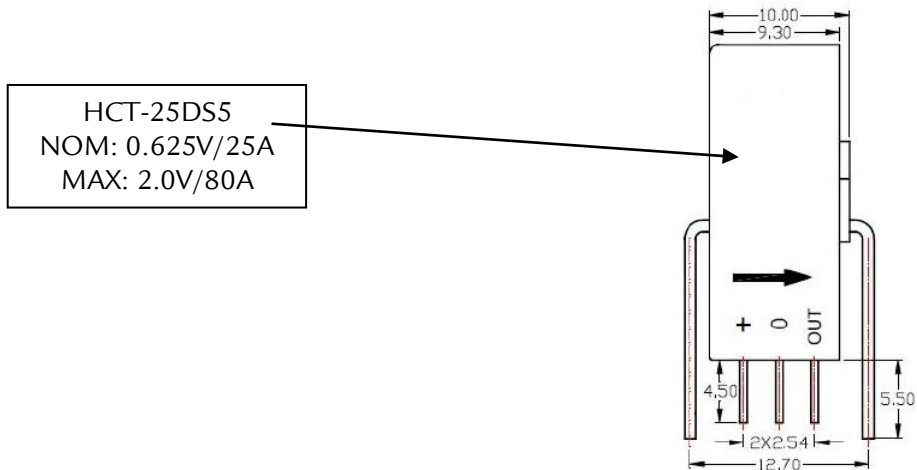

NOTES

All rights reserved. Passing on of this document, use and communication of contents not permitted without written authorisation.

	CUSTOMER	CUSTOMER CODE	PART DESCRIPTION HALL EFFECT CURRENT SENSOR CLOSED LOOP 6A		
	INTERNAL CODE HCT-DS5	DATE 28/10/10	EDITION 2	DOCUMENT NAME HCT-DS5_2.doc	PAGE 11/17

2.- ELECTRICAL PARAMETERS

Primary Nominal Current	25 A DC	I_{pn}
Measuring Range	80 A	I_p
Reference voltage	$2.5 \pm 0.5\% V$	V_o
Turns	2000 ± 1	N
Supply Voltage	$+5 \pm 5\% V$	V_{cc}
Rated output (V)	$0.625 \pm 0.5\%$	
Sample resistance inside	$50 \pm 0.1\% \Omega$	R_{IN}

3.- ACCURACY

Linear Error	< 0.1 % Full Scale	e_{LLR}
Total precision	± 0.7	
Offset Current Drift	$< \pm 0.5\% mV/^\circ C$	K_{Ios}
Time Response ($di/dt > 50 A/\mu S$)	< 500ns	T_R
Frequency Bandwidth	DC to 200kHz (-1dB)	F_c

4.- GENERAL DATA

Operating Temperature	-40 to +85 °C	T_A
Storage Temperature	-40 to +125 °C	T_s

5.- ISOLATION CHARACTERISTICS

Galvanic isolation (50 Hz, 1min)	3.0 KV	V_I
Impulse withstand voltage 1.2/50 μs	>8 KV MIN	V_w
Creepage distance	15.5 mm	d_{Cp}
Clearance distance	6.35 mm	d_{CI}

STANDARDS

	EN 50178	UL 508C
Rating isolation voltage	600V	600V
Pollution degree	2	2
CTI group	III	III

Notes:

- To be certificated
- The transducer is also designed according to EN-60974-1:2004

NOTES

All rights reserved. Passing on of this document, use and communication of contents not permitted without written authorisation.

	CUSTOMER	CUSTOMER CODE	PART DESCRIPTION HALL EFFECT CURRENT SENSOR CLOSED LOOP 6A		
	INTERNAL CODE HCT-DS5	DATE 28/10/10	EDITION 2	DOCUMENT NAME HCT-DS5_2.doc	PAGE 12/17

5.- MOUNTING DIMENSIONS (FOR REFERENCE ONLY)

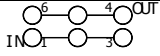
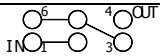
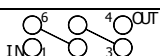
Turns	Primary rated current IPN[A]	Rated putout voltage VOUT[V]	Primary resistance [mΩ]	Primary Inductance [uH]	Connect point
1	±25	2.5±0.625	0.18	0.013	
2	±12.5	2.5±0.625	0.81	0.05	
3	±8.3	2.5±0.625	1.62	0.12	

6.- EDITION CONTROL

Edition	Date	Change description	Made by
1st	25/08/10	First Edition	Marta Escolar
2nd	15/10/10	Update galvanic isolation Include general standards	Marta Escolar
3rd	29/10/10	Include marking, standards and isolations characteristics and updated mounting dimensions	Marta Escolar

NOTES

All rights reserved. Passing on of this document, use and communication of contents not permitted without written authorisation.

	CUSTOMER	CUSTOMER CODE	PART DESCRIPTION HALL EFFECT CURRENT SENSOR CLOSED LOOP 6A		
	INTERNAL CODE HCT-DS5	DATE 28/10/10	EDITION 2	DOCUMENT NAME HCT-DS5_2.doc	PAGE 13/17

NOTES



All rights reserved. Passing on of this document, use and communication of contents not permitted without written authorisation.

	CUSTOMER	CUSTOMER CODE	PART DESCRIPTION HALL EFFECT CURRENT SENSOR CLOSED LOOP 6A		
	INTERNAL CODE HCT-DS5	DATE 28/10/10	EDITION 2	DOCUMENT NAME HCT-DS5_2.doc	PAGE 14/17

HCT-50DS5 SERIES HALL EFFECT CURRENT SENSOR CLOSED LOOP

NOTES



All rights reserved. Passing on of this document, use and communication of contents not permitted without written authorisation.

	CUSTOMER	CUSTOMER CODE	PART DESCRIPTION HALL EFFECT CURRENT SENSOR CLOSED LOOP 6A	
	INTERNAL CODE HCT-DS5	DATE 28/10/10	EDITION 2	DOCUMENT NAME HCT-DS5_2.doc

1.- DIMENSIONS AND PINS CONFIGURATION

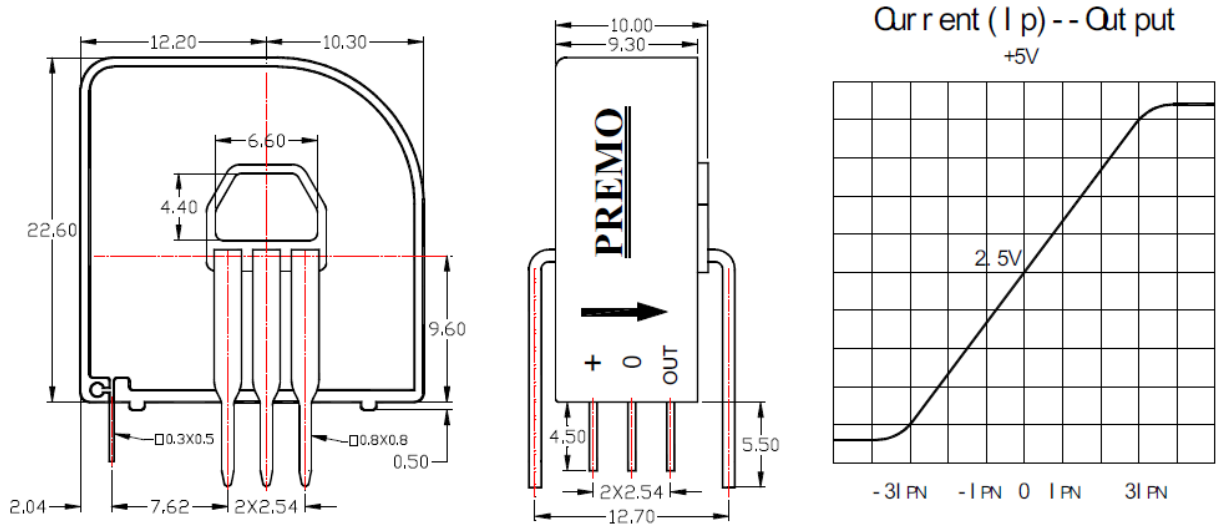

All dimensions are in mm.

General Tolerance ± 0.5 mm.

All dimensions and mechanical fixations are subjected to change depending on the customer necessities and PREMO Transducer Development.

NOTES

All rights reserved. Passing on of this document, use and communication of contents not permitted without written authorisation.

	CUSTOMER	CUSTOMER CODE	PART DESCRIPTION HALL EFFECT CURRENT SENSOR CLOSED LOOP 6A		
	INTERNAL CODE HCT-DS5	DATE 28/10/10	EDITION 2	DOCUMENT NAME HCT-DS5_2.doc	PAGE 16/17

2.- ELECTRICAL PARAMETERS

Primary Nominal Current	50 A DC	I_{pn}
Measuring Range	150 A	I_p
Galvanic isolation (50 Hz, 1min)	3 KV	
Turns	2000±1	
Supply Voltage	+5±5% V	V_{CC}
Rated output (V)	0.625±0.5%	
Sample resistor inside	25±0.1% Ω	
Reference voltage	2.5±0.5% V	

3.- ACCURACY

Linear Error	< 0.1 % Full Scale	e_{LLR}
Total precision	±0.7	
Offset Current Drift	<± 0.5 % mV/°C	K_{Ios}
Time Response ($di/dt > 50 \text{ A}/\mu\text{S}$)	< 500ns	T_R
Frequency Bandwidth	DC to 200kHz (-1dB)	F_c

- * Electrical Parameters and frequency response to be checked with samples.

4.- GENERAL DATA

Operating Temperature	-40 to +85 °C	T_A
Storage Temperature	-40 to +125 °C	T_s

5.- MOUNTING DIMENSIONS (FOR REFERENCE ONLY)

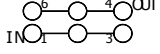
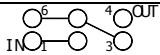
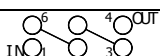
Turns	Primary rated current $I_{PN}[A]$	Rated putout voltage $V_{OUT}[V]$	Primary resistance [mΩ]	Primary Inductance [uH]	Connect point
1	±6(±15,±25,±50)	2.5±0.625	0.18	0.013	
2	±3(±7.5,±12.5,±25)	2.5±0.625	0.81	0.05	
3	±2(±5,±8.3,±16.6)	2.5±0.625	1.62	0.12	

NOTES

All rights reserved. Passing on of this document, use and communication of contents not permitted without written authorisation.

	CUSTOMER	CUSTOMER CODE	PART DESCRIPTION HALL EFFECT CURRENT SENSOR CLOSED LOOP 6A		
	INTERNAL CODE HCT-DS5	DATE 28/10/10	EDITION 2	DOCUMENT NAME HCT-DS5_2.doc	PAGE 17/17

5.- EDITION CONTROL

Edition	Date	Change description	Made by
1 st	25/08/10	First Edition	Marta Escolar
2 nd	15/10/10	Updated the Galvanic isolation value	Marta Escolar

NOTES

All rights reserved. Passing on of this document, use and communication of contents not permitted without written authorisation.